



genesis innovations, llc

4004 Medford Dr. Loveland, CO 80538 (888) 635-2500 Fax (970) 635-9316

CABINET CLEANING AND CARE GUIDE

Cleaning:

- Remove spills from surface immediately, do not allow to dry.
- Wash with warm water and mild detergent. Do NOT use abrasive cloth, eg. Scotch-Brite®, or harsh chemicals because they WILL damage the finish. Dry with a soft cloth.

Wax and Polish:

- Do NOT use any product that contains Petroleum Distillates or solvents. They WILL Damage the Finish.

Door Adjustment:

- Adjustment: Genesis uses a high quality concealed hinge that utilizes 3-axis adjustments, as illustrated below.

Three-dimensional adjustment

Side adjustment

Turn front screw to increase or decrease door overlay (+/-2mm).

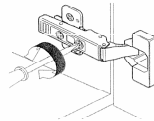
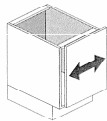

Height adjustment

Rotate cam screw on mounting plate to adjust door position (+/-2mm).

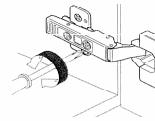
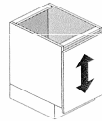

Depth adjustment

Turn rear spiral-tech cam screw to adjust door position (+3mm, -2mm).

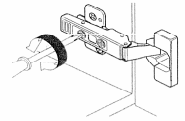
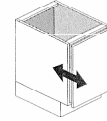

On non-cam mounting plates loosen screw, adjust door and retighten screws.

For CLIP, loosen rear screw, adjust and retighten.

Drawer Removal:

- Removal: Genesis uses a high quality under-mount drawer guide system that utilizes a quick release under the drawer, as illustrated below. Reach under drawer, squeeze orange lever, as shown in picture, and lift drawer up and out, off guides. To reinsert drawer, simply rest drawer on guides and push fully closed, to reengaged mechanism.

TANDEM drawer removal and height adjustment

Drawer removal

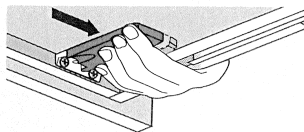

1. Squeeze orange handles on locking devices.
2. Pull drawer out and up.

Drawer installation

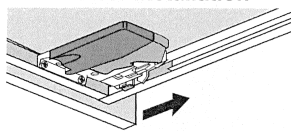

Place drawer on runners and close, locking devices will automatically engage runners.

Height adjustment

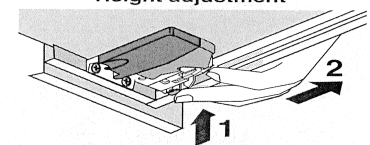

1. Press up on adjustment latch.
2. Push towards back of drawer. Max. 3mm (1/8") rise of drawer

Small Nick and Scratch Repair:

- Clean area and let dry thoroughly.
- Touch-up scratch with "Stain Pen" and wipe clean and dry with soft cloth.
- If surface is gouged into wood, clean area, let dry thoroughly. Fill gouge until smooth, with matching-color putty stick. Carefully buff repaired area with soft cloth to blend filled area with surrounding finish.